

JF-STOLL

Drum Mower

CM 170 | CM 190

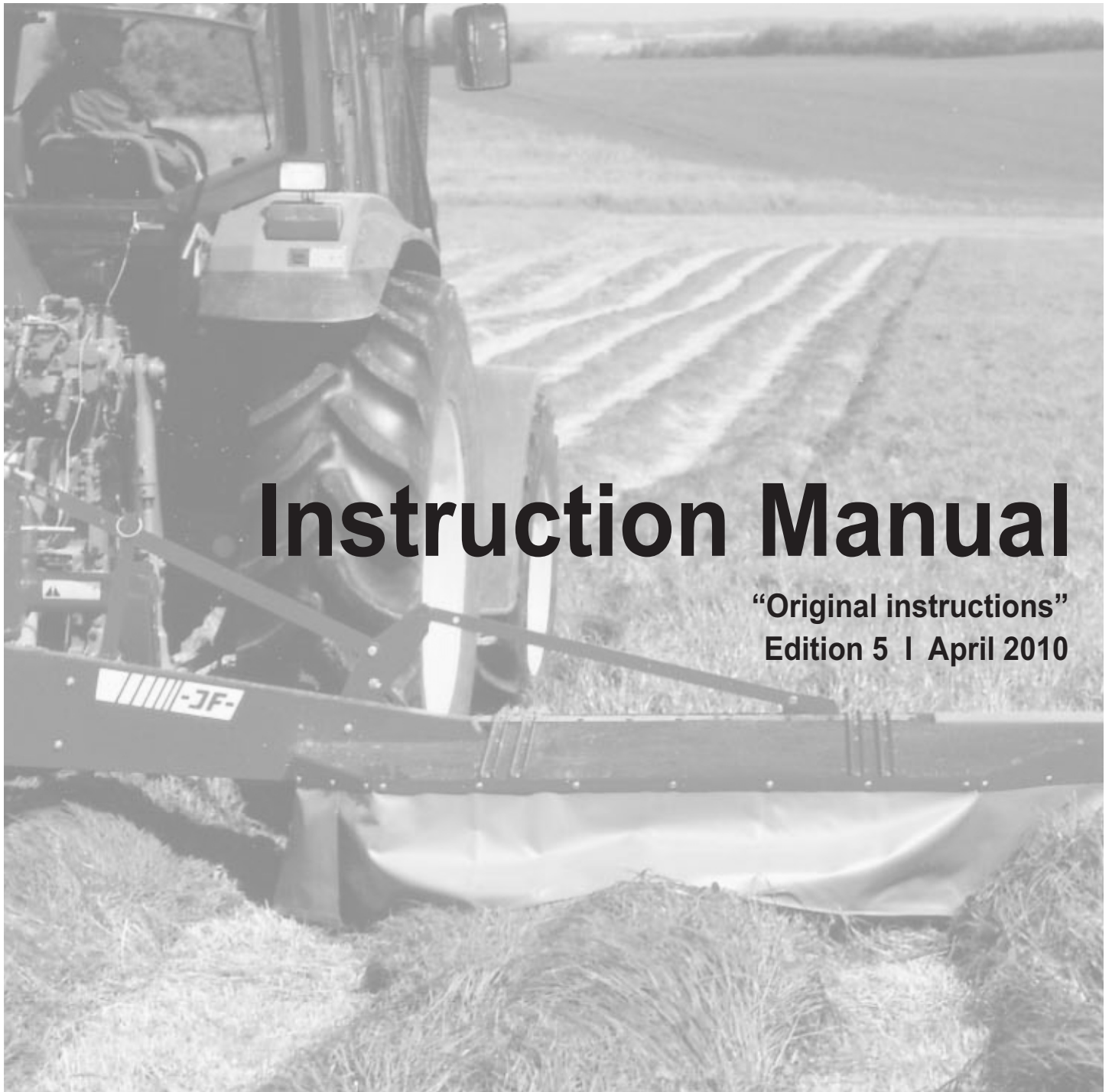

Instruction Manual

“Original instructions”

Edition 5 | April 2010

EN EC-Declaration of Conformity
according to Directive 2006/42/EC

DE EG-Konformitätserklärung
entsprechend der EG-Richtlinie 2006/42/EC

IT Dichiarazione CE di Conformità
ai sensi della direttiva 2006/42/EC

NL EG-Verklaring van conformiteit
overeenstemming met Machinerichtlijn 2006/42/EC

FR Déclaration de conformité pour la CEE
conforme à la directive de la 2006/42/EC

ES CEE Declaración de Conformidad
según la normativa de la 2006/42/EC

PT Declaração de conformidade
conforme a norma da C.E.E. 2006/42/EC

DA EF-overensstemmelseserklæring
i henhold til EF-direktiv 2006/42/EC

PL Deklaracja Zgodności CE
według Dyrektywy Maszynowej 2006/42/EC

FI EY : N Vaatimustenmukaisuusilmoitus
täyttää EY direktiivin 2006/42/EC

EN We,
DE Wir,
IT Noi,
NL Wij,
FR Nous,
ES Vi,
PT Me,
DA Vi,
PL Nosotros,
FI Nös,

JF-Fabriken - J. Freudendahl A/S
Linde Allé 7
DK 6400 Sønderborg
Dänemark / Denmark
Tel. +45-74125252

EN **declare under our sole responsibility, that the product:**
DE erklären in alleiniger Verantwortung, dass das Produkt:
IT Dichiaro sotto la propria responsabilità che il prodotto:
NL verklaren als enig verantwoordelijken, dat het product:
FR déclarons sous notre seule responsabilité que le produit:

ES declaramos bajo responsabilidad propia que el producto:
PT declaramos com responsabilidade própria que o produto:
DA erklærer på eget ansvar, at produktet:
PL deklarujemy z pełną odpowiedzialnością, iż produkt:
FI ilmoitamme yksin vastaavamme, että tuote:

EN **Model:**
DE Typ :
IT Tipo :
NL Type :
FR Modèle :
ES modelo :
PT Marca :
DA Typ :
PL Model :
FI Merkki :

CM 170
CM 190

EN **to which this declaration relates corresponds to the relevant basic safety and health requirements of the Directive:**

2006/42/EC

DE auf das sich diese Erklärung bezieht, den einschlägigen grundlegenden Sicherheits- und Gesundheitsanforderungen der EG 2006/42/EC

IT E' Conforme ai Requisiti Essenziali di Sicurezza a di tutela della Salute di cui alla Direttiva e sue successive modificazioni: 2006/42/EC

NL waarop deze verklaring betrekking heeft voldoet aan de van toepassing zijnde fundamentele eisen inzake veiligheid en gezondheid van de EG-machinerichtlijn no: 2006/42/EC

FR faisant l'objet de la déclaration est conforme aux prescriptions fondamentales en matière de sécurité et de santé stipulées dans la Directive de la: 2006/42/EC

ES al cual se refiere la presente declaración corresponde a las exigencias básicas de la normativa de la y referentes a la seguridad y a la sanidad:

2006/42/EC

PT a que se refere esta declaração corresponde às exigências fundamentais respectivas à segurança e à saúde de norma da 2006/42/EC

DA som er omfattet af denne erklæring, overholder de relevante grundlæggende sikkerheds- og sundhedskrav i EF-direktiv sam: 2006/42/EC

PL dla którego się ta deklaracja odnosi, odpowiada właściwym podstawowym wymogom bezpieczeństwa i ochrony zdrowia Dyrektywy Maszynowej: 2006/42/EC

FI johon tämä ilmoitus liittyy, vastaa EY direktiivissä mainittuja perusturvallisuus- ja terveysvaatimuksia (soveltuvin osin) sekä muita siihen kuuluvia EY direktiivejä: 2006/42/EC



Konstruktion (Design) + Produktion (Production)
Sønderborg, 15.12.2009 Jørn Freudendahl

INSTRUCTION MANUAL FOR DRUM MOWER

| Contents: | PAGE: |
|-------------------------------------|--------------|
| Mounting on tractor | 3 |
| Driving in the field | 5 |
| Safety release | 5 |
| Conversion to transport position | 5 |
| Replacement of blades | 5 |
| Manual adjustment of stubble height | 7 |
| Blades for short stubble | 7 |
| Lubrication | 7 |
| Assembly of guard | 9 |
| Warranty | 11 |

IMPORTANT!

Retighten the bolts of your new machine after a few hours work.

| TECHNICAL DATA: | | CM 170 | CM 190 |
|--|---------------|-----------------------------------|---------------|
| Working width | | 1,65 m | 1,90 m |
| Area capacity up to | | 1,7 ha/h | 1,9 ha/h |
| Power requirement at 540 RPM from | | 23 kW/30 HP | 30 kW/40 HP |
| Number of rotors | | 2 | 2 |
| Number of blades (easy to replace) | | 2 x 3 | 2 x 3 |
| Blade speed | | 83 m/sec. | 83 m/sec. |
| Variable stubble height adjustment | | 30-45 mm | 30-40 mm |
| Swath width | | 0,85 m | 1,0 m |
| Weight | | 390 kg | 480 kg |
| Transport width | | Within the width of most tractors | |
| Safety release | | Standard | Standard |
| Turnable guide shoes | | Standard | Standard |
| PTO-shaft with free-wheel | | Standard | Standard |
| Safety canvas, better than norm, 1000 g/m ² | | Standard | Standard |
| Noise level in tractor cabin | Window open | 92,5 dB(A) | 92,5 dB(A) |
| | Window closed | 76,5 dB(A) | 76,5 dB(A) |

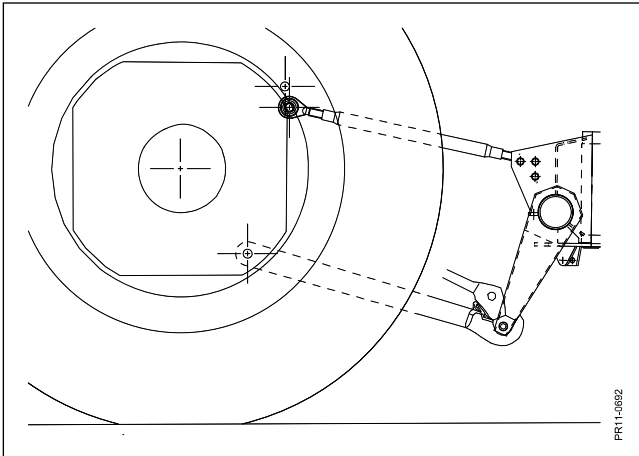

Fig. 1

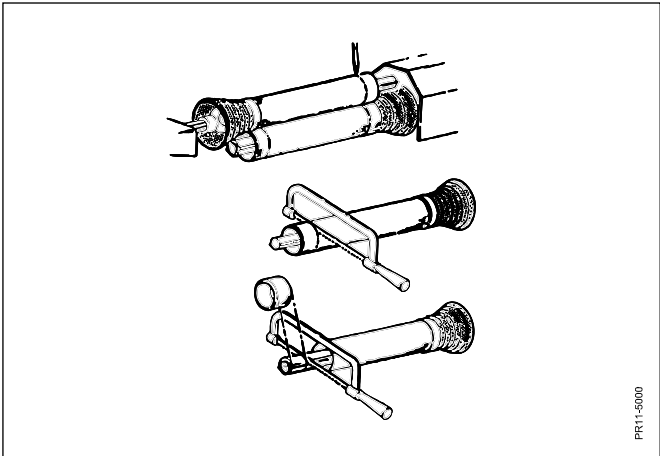

Fig. 2

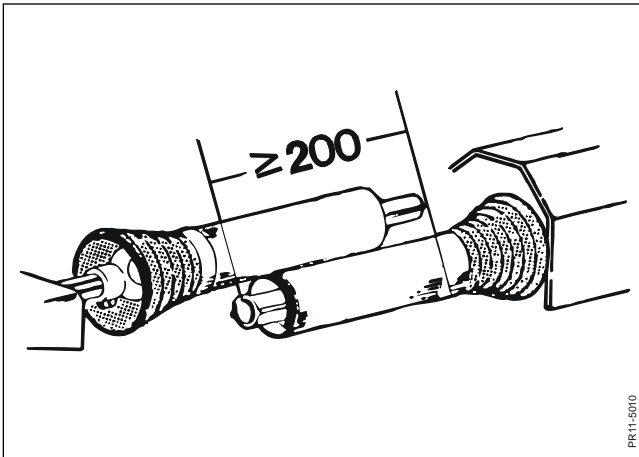

Fig. 3

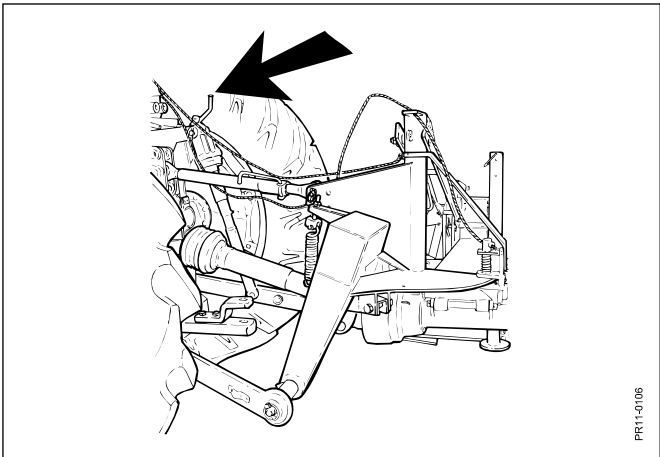

Fig. 4

MOUNTING ON TRACTOR

FIRST MOUNTING

FIG. 1 The tractor's lift arms are connected to the dowels on the top frame and thereafter the top rod is mounted.

The tractor's lift arms must be side stabilized so that the machine has exactly the full swath width.

Raise the jack.

The drum mower is mounted in the 3-point linkage of the tractor. It is raised and lowered by the lift.

The top rod is mounted as parallel as possible to the lift arms in order to avoid that the angle of inclination is changed when the machine is raised by the tractor lift.

FIG. 2 Check the length of the PTO-shaft.

FIG. 3 Mount the PTO-shaft on the PTO of the tractor and check that the shaft has a mesh of at least 200 mm in working position. Also check that it has freedom of movement in both raised and lowered position. If the shaft is too long it must be shortened to the wanted length.

After shortening the tube and shaft ends are rounded by a file and cleaned. Then the tubes are lubricated.

Fig. 4 The spindle for the right lift arm is adjusted so that the lifted machine hangs straight.

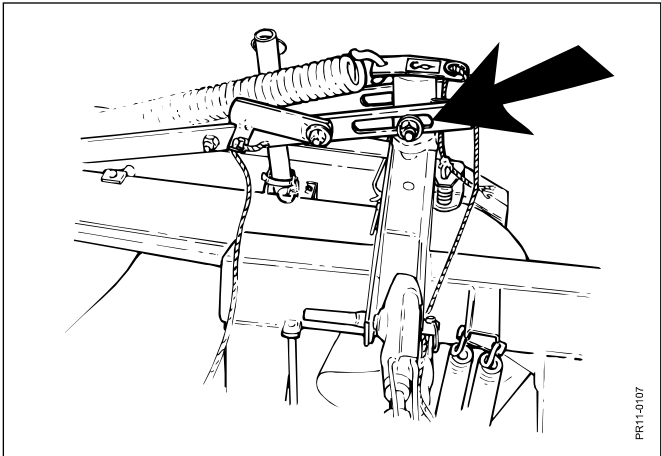

Fig. 5

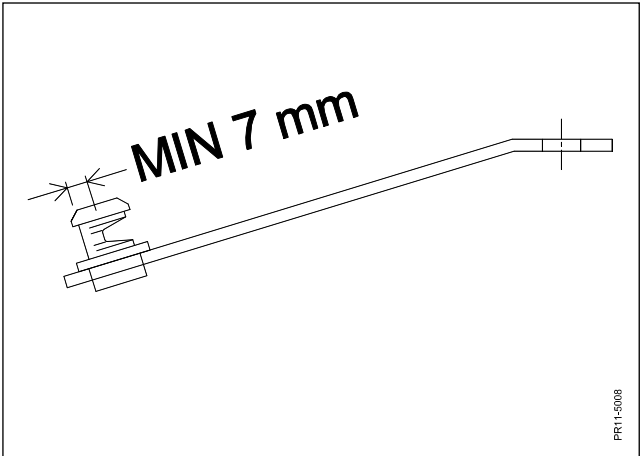

Fig. 6

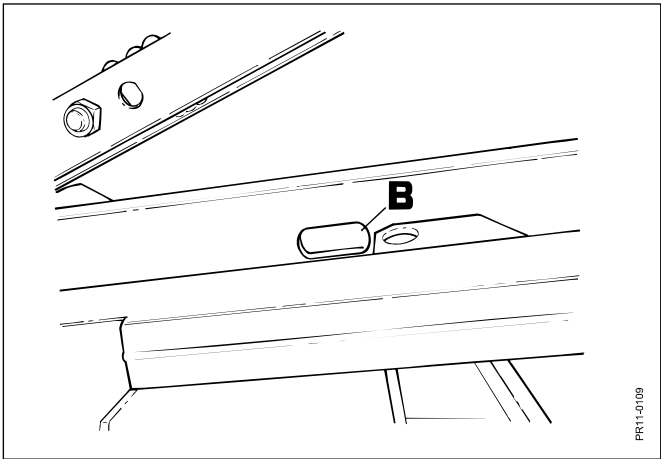

Fig. 7

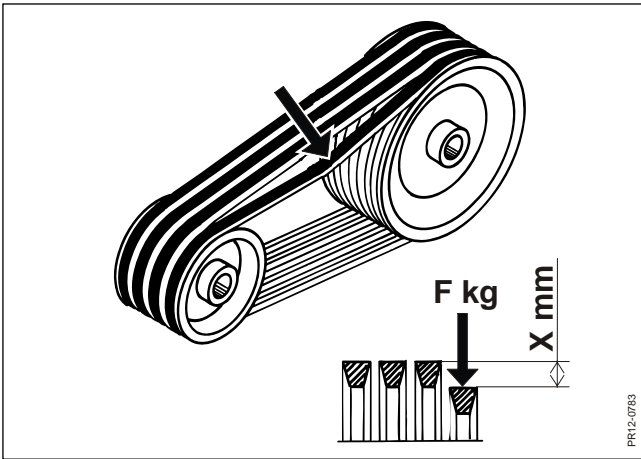

Fig. 8

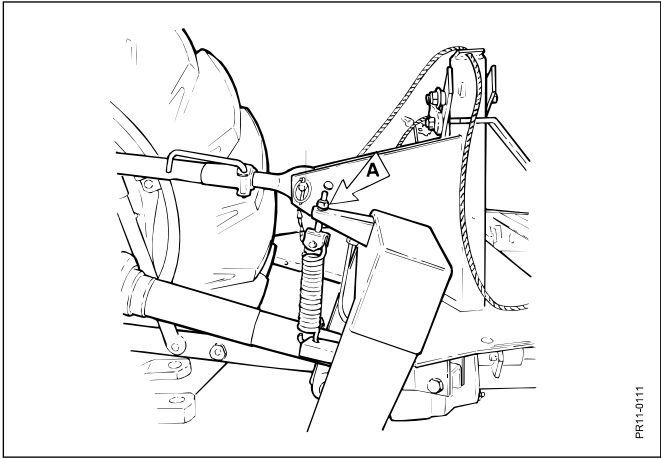

Fig. 9

DRIVING IN THE FIELD

When the machine is in working position the length of the top rod is adjusted so that the guide shoes are horizontal or with a slight forward tilt. A backward tilt cannot be recommended as the machine will then recut.

Bring the machine to full number of revolutions – 540 RPM – before driving into the crop.

FIG. 5 The lift arms are raised so that there is approx. 10 mm free motion in the oblong hole.
Adjust the lift stop so that this height is easily found again.

The machine should only be lifted for short periods when working.

At regular intervals it is important to check:

FIG. 6 If the blade holders are worn. If the blade holder rivet is worn half-way through the blade holder must be replaced.

If the blade can move freely.

FIG. 7 If the V-belts are tight enough. **Hole B.**

Fig. 8 Normally, the belt is tightened correctly when a force of $F=7,5$ daN (kg) gives a deflection of $X = 30 - 35$ mm on the middle of the belt.

SAFETY RELEASE

FIG. 9 The drum mower is provided with a safety release allowing the boom to swing backwards when the front pressure becomes too heavy, e.g. when the machines drives against firm objects such as a tree, a pole, earthfast stones etc. If the safety release has been activated it is brought back into mesh in working position by driving backwards with a strong jerk. If the machine releases too easily while driving the spring is tightened a little more **A.**

Do not tighten the spring so much that the release is blocked.

READJUSTMENT TO TRANSPORT POSITION

1. The machine is lowered a little more than in working position.
2. Wait until the rotors have stopped rotating.
3. Pull the string, drive forward and at the same time turn the steering wheel sharply to the left.
4. Let go of the string and drive on until dowel is engaged.
5. Lift the machine. Make sure that no persons are near machine and tractor.
6. Test if the dowel is correctly engaged before driving on public roads

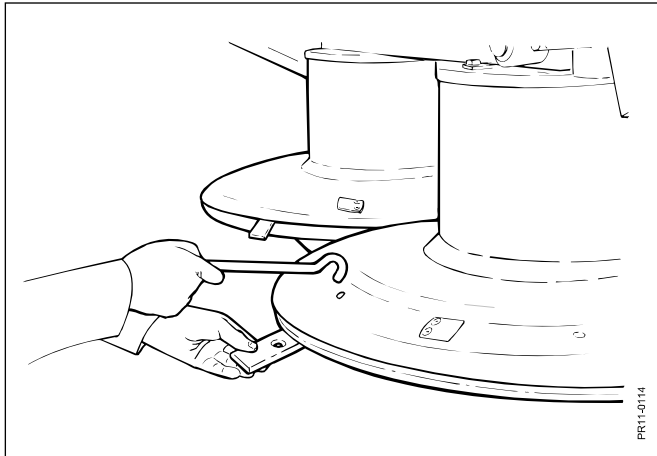

Fig. 10

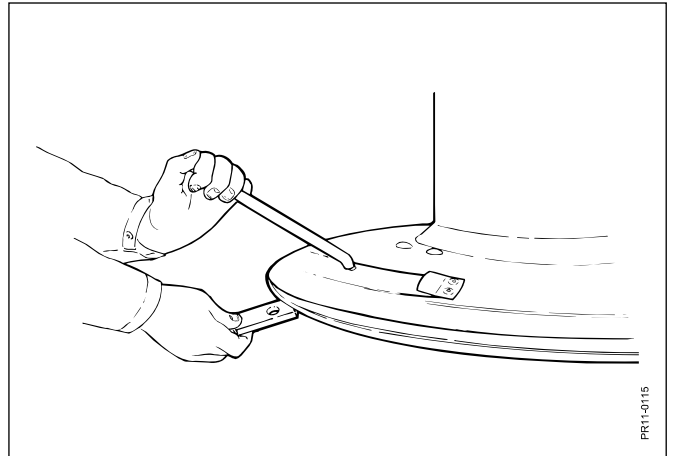

Fig. 11

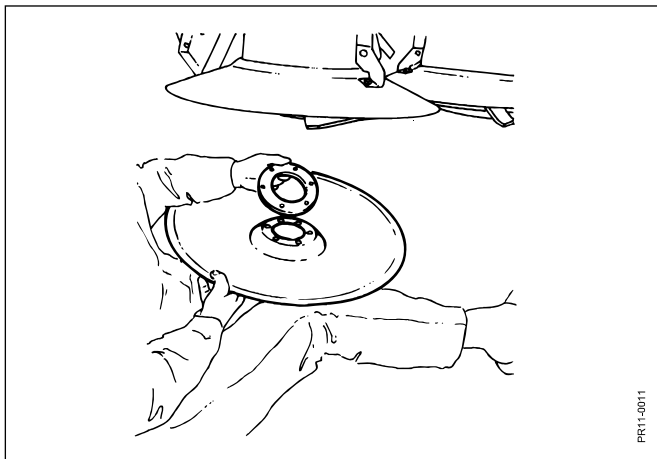

Fig. 12

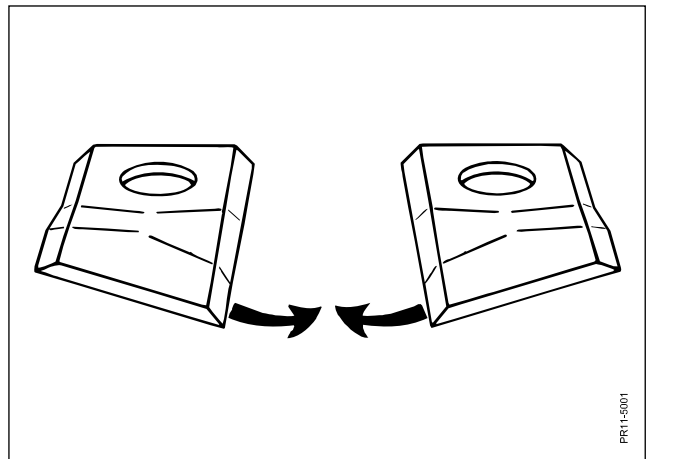

Fig. 13

REPLACEMENT OF BLADES

FIG. 10 The supplied tool is placed through the hole in the drum plate and turned halfway round, and with a pressure the blade is released.

FIG. 11 Insert a new original JF-blade.

In order to secure the balance of the drum, the blades must be replaced in sets.

If strong vibrations occur in the drums for no apparent reason it may be due to accumulation of dirt in the drums. Check the drums at regular intervals and clean them carefully, if required, i.e. remove the guide shoes and the rotors to have access to the drums. Especially when starting work after winter storage some dirt may loosen and the remaining dirt may cause the rotors to get off balance resulting in vigorous vibrations.

The blades have 2 edges, and can be worn on 2 sides. Straight blades (1380-0025) are mowed to the neighbouring rotor. Twisted blades (1380-0024, 1380-0023) are turned round.

MANUAL ADJUSTMENT OF STUBBLE HEIGHT

FIG. 12 From the factory the machine has been equipped with guide shoes providing a stubble height of 30 to 45 mm. The stubble height can be adjusted with a 10 mm intermediate washer (option) that is placed between the hub and the guide shoe. The guide shoe can be dismantled by removing 6 screws.

Washer: 2320-098X (CM 170)
2320-374X (CM 190)

BLADE FOR SHORT STUBBLE

FIG. 13 To be used in crops where shorter stubble is required.

Right blade Order no. 1380-0023

Left blade Order no. 1380-0024.

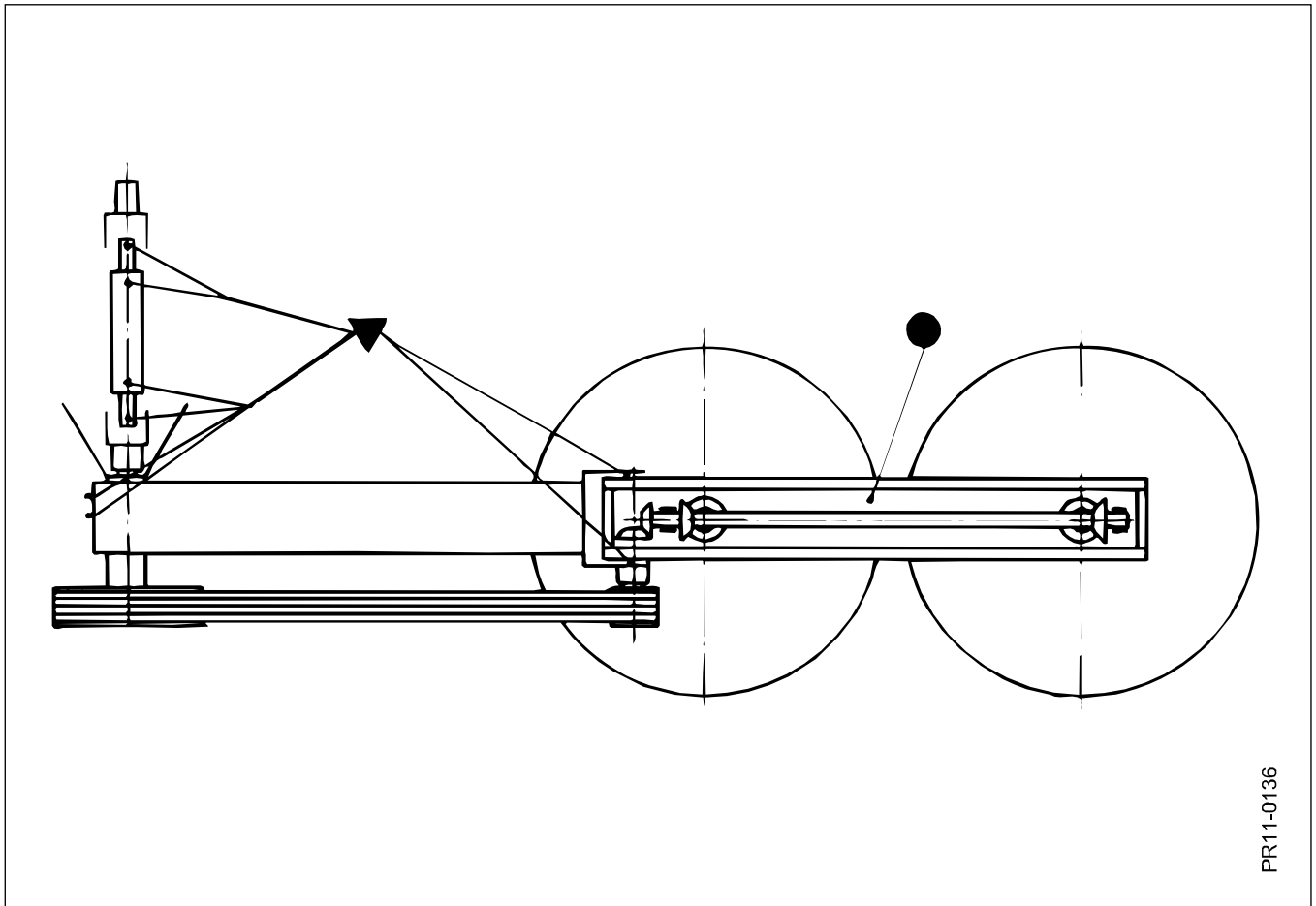

Fig. 14

GREASING

FIG. 14 Grease daily:

The PTO-shaft 4 spots

The top frame's swivel link 2 spots

The swivel link by the gearbox 2 spots

The gearbox is filled with "**Shell Alvania RO**" **special grease**. It is unnecessary to check the grease level. If - after repair - refilling of grease is required **only that grease must be used**. Refill to the shaft's underside.

CM 190 ASSEMBLY OF PROTECTION

 M8x20

 $\varnothing 8.2 \times 17 \times 1.5$

 M8

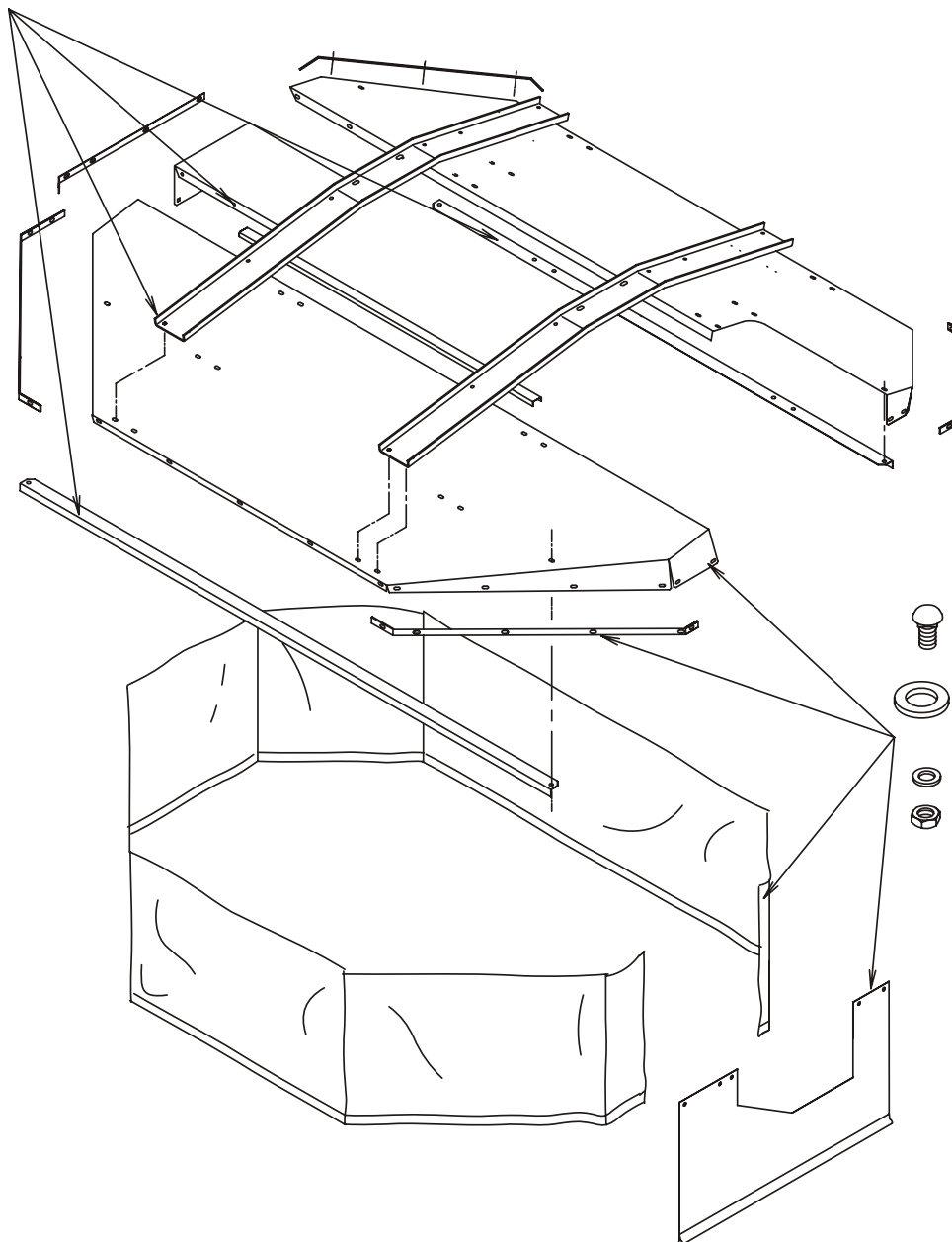

 M8x20

 $\varnothing 10.5 \times 22 \times 3$

 $\varnothing 8.2 \times 17 \times 1.5$

 M8

CM 170 ASSEMBLY OF PROTECTION

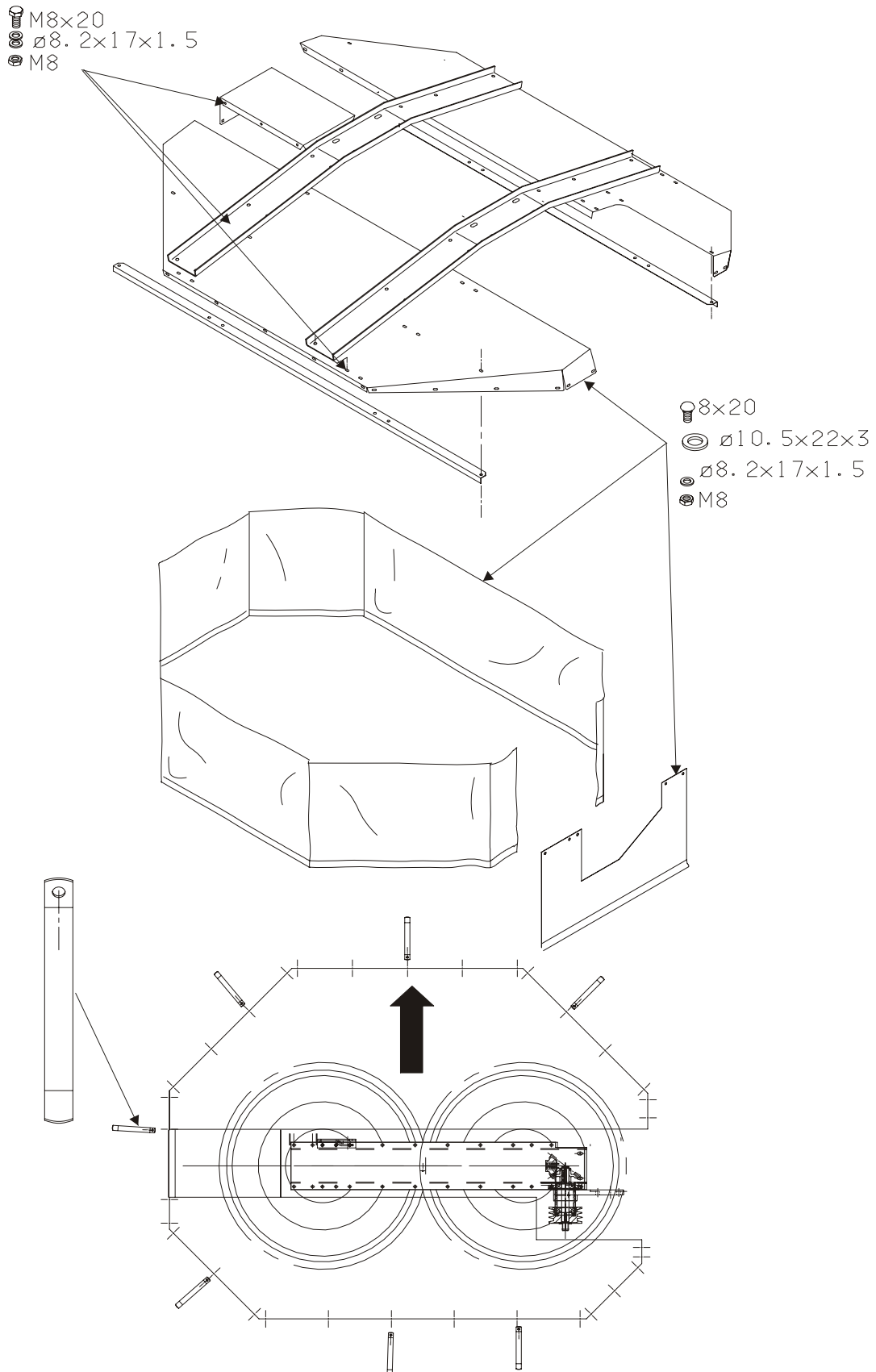

WARRANTY

JF-Fabriken - J. Freudendahl A/S, 6400 Sønderborg, Denmark, hereafter called "**JF**", grants warranty to any buyer of new JF-STOLL machines from authorized JF-STOLL dealers.

The warranty covers remedy of material and production faults. This warranty is valid within a year after date of sale to end-user.

The warranty is invalidated in the following cases:

1. **The machine has been used for other purposes than those described in the instruction manual.**
2. **Improper use.**
3. **Damage caused by external sources, e.g. lightning or falling objects.**
4. **Insufficient maintenance.**
5. **Transport damage.**
6. **The construction of the machine has been modified without JF's written permission.**
7. **Unskilled repair of the machine.**
8. **Unoriginal spare parts have been used.**

JF cannot be held responsible for loss of income or legal claim as a result of faults either of the owner or of a third party. Nor is JF responsible for wages beyond current agreements in connection with replacement of warranty parts.

JF is not responsible for the following costs:

1. **Normal maintenance such as expenses for oil, grease and minor adjustments.**
2. **Transport of machine to and from workshop.**
3. **The dealer's travelling expenses or freight charges to and from the user.**

Warranty is not granted on wearing parts unless it can clearly be proved that JF has committed a fault.

The following is regarded as wearing parts:

Protective canvases, blades, blade suspensions, wearing bars, guide shoes, stone protections, discs, rotor skirts, crimper parts, tyres, tubes, brake shoes, chain tightener parts, guards, hydraulic hoses, conveyors, vertical auger and tub, wheel-fixing bolts and nuts, snap rings, sockets, PTO-shafts, clutches, gaskets and seals, tooth belts, V-belts, chains, sprocket wheels, carriers, conveyor chain slats, rake- and pick-up tines, rubber seals, rubber paddles, cutter blades, chute liner and lining for spreading platform, shredding blades incl. bolts and nuts, spreading rotors and vanes for farmyard manure spreaders.

In addition, the user must note the following:

1. **The warranty is only valid if the dealer has undertaken a pre-delivery check and has given instruction to the end user in the use of the machine.**
2. **The warranty cannot be transferred to others without JF's written permission.**
3. **The warranty can be nullified if repair is not undertaken immediately.**



Specialist in grassland machinery and complete diet mixers

When it comes to green feed techniques, JF-STOLL has gained a reputation as one of the world's leading suppliers and specialists. As a specialist manufacturer for over 50 years, we have gained a vast amount of experience from right around the world and, more importantly, unique regional requirements.

We also receive important inspiration in our development work through a close and continuous dialogue with customers, dealers and agricultural researchers.

No matter which type of JF-STOLL-machine you chose, you can be sure to obtain the best result to obtain a top result - in the shape of high performance and operational reliability, minimum maintenance, flexible working possibilities and optimal operating economy.

Dealer

JF-STOLL

JF-Fabriken · J. Freudendahl A/S
Linde Allé 7 · Postbox 180
DK-6400 Sønderborg · Denmark
Phone. +45 74 12 51 51 · Fax +45 74 42 52 51
www.jf-stoll.com